

Thank you for purchasing the **Modular Cork Wall Rail**. This page lists all the contents included in the box. Please take the time to identify the hardware as well as the individual components to this product. As you unpack and prepare for assembly, place the contents on a carpeted or padded area to protect them from damage.

Note: 2 people are required to safely install this product.

 **WARNING:** Adult Assembly Required

## MOUNTING HARDWARE



2 - screws      2 - plastic anchors

Missing hardware? Please call **800.933.9904** for replacements.

## TOOLS REQUIRED

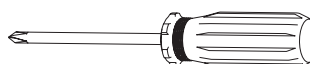

Phillips head screwdriver

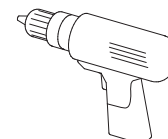

power drill  
(for pilot holes only)

(We recommend the use of hand tools instead of power tools)

## COMPONENTS

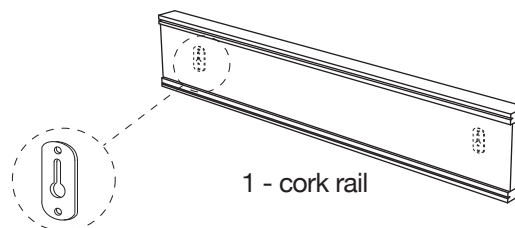

1 - cork rail

## WALL MOUNTING INSTRUCTIONS

For added safety and stability, it is recommended that the wall mounting hardware be installed. For safe mounting, it is essential to use wall anchors appropriate to your wall type (i.e. plaster, drywall, concrete, etc.). Mount to wood studs whenever possible. The following instructions are for drywall mounting only:

- A. Determine where you wish to hang the cork rail and mark on the wall where the 2 anchors should be inserted. The distance between the 2 keyhole hanging brackets is 16". Make sure both marks are level.
  - B. Drill a pilot hole for each anchor slightly smaller than the diameter of the drywall anchor.
  - C. Insert 1 **plastic anchor** into each hole until the head of the anchor is flush with the surface of the wall. Gently tap with a hammer if necessary.
  - D. Fasten 1 **screw** with a **Phillips head screwdriver** into each **plastic anchor**, leaving approximately 1/4" of the screw projecting from the face of the wall.
  - E. With the assistance of another person, fit the screw heads into the corresponding keyhole hanging hardware as shown. Make sure each screw head securely engages each keyhole bracket fitting.
- Wall mounting is now complete.

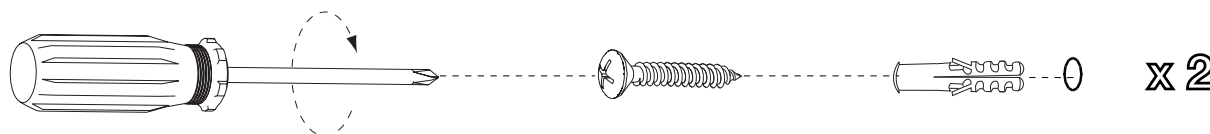

**CLEANING AND CARE** Clean surfaces with a dry or damp soft cloth. Do not use abrasive cleaners.